

TRAFFIC SWINGING SINGLE LEAF DOORS WITH GRAVITY HINGES

ALL PRICES IN US DOLLARS, 2 MM THICK DOOR FRAME INCLUDED, VAT NOT INCLUDED

(TSD GR)

30.10.2023

- PH Insulation's traffic swinging doors are designed to separate premises with intensive traffic of personnel. The factory-made doors are ready for installation in supermarkets, restaurants, hospitals, food production facilities, etc. Doors can be equipped with oval windows of 200x500 or 300x580 mm.
- PH Insulation's doors with gravity hinges are set up faster with less adjustment compared to fixating hinges, need less maintenance and provide for increased dimensions of light opening.
- PH Insulation's traffic doors are not meant to completely seal the opening due to technical clearance gaps along the perimeter between the frame and the door leaf.

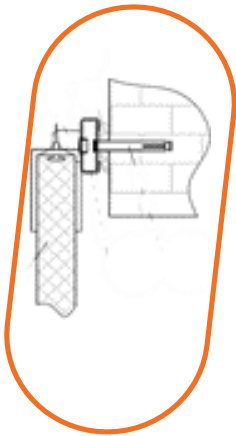

OVERHEAD FRAME

INSTALLATION OPENING, HEIGHT, MM	INSTALLATION OPENING, WIDTH, MM						
	700	800	900	1000	1100	1200	1300
1800	331	365	372	382	389	404	415
1900	335	370	378	388	396	411	422
2000	339	376	383	395	402	418	429
2100	343	382	389	401	408	424	436
2200	348	388	396	408	416	432	444
2300	352	394	402	414	422	439	451
2400	357	401	409	421	430	447	459
2500	361	407	415	428	436	453	467
2600	368	417	425	438	447	465	478
2700	373	424	432	446	455	473	487
2800	379	431	439	453	462	481	495
2900	385	439	448	462	472	491	505
3000	390	446	455	470	479	499	513
3100	394	452	461	476	485	505	520
3200	399	458	468	483	493	513	529
3300	407	469	479	494	504	525	540

RAL 9003

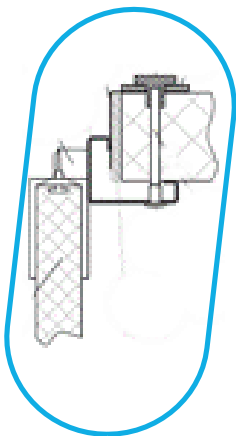

ANGULAR FRAME

INSTALLATION OPENING, HEIGHT, MM	INSTALLATION OPENING, WIDTH, MM						
	700	800	900	1000	1100	1200	1300
1800	348	383	390	402	409	425	437
1900	353	390	397	409	417	433	445
2000	358	396	404	416	424	440	453
2100	364	404	412	424	432	449	462
2200	369	411	419	432	441	458	471
2300	374	418	426	439	448	465	479
2400	379	424	433	446	455	473	487
2500	384	431	440	454	463	481	495
2600	391	441	450	464	473	492	507
2700	398	449	459	473	482	502	517
2800	404	458	467	482	491	511	527
2900	411	466	476	491	501	521	537
3000	415	471	481	497	507	528	543
3100	420	479	489	505	515	536	552
3200	430	491	502	517	528	550	566
3300	436	499	509	525	537	559	576

RAL 9003

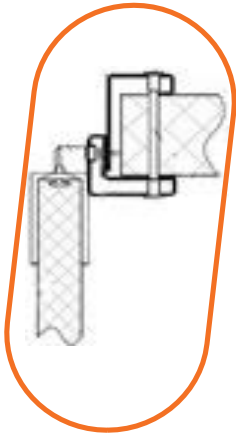
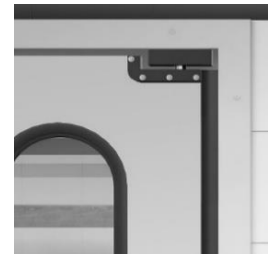

OVERLAPPING FRAME

INSTALLATION OPENING, HEIGHT, MM	INSTALLATION OPENING, WIDTH, MM						
	700	800	900	1000	1100	1200	1300
1800	410	447	456	471	480	499	514
1900	417	456	465	480	490	509	524
2000	425	467	476	491	501	522	537
2100	432	476	485	501	511	532	547
2200	441	486	497	512	523	544	560
2300	449	496	506	522	533	555	571
2400	460	509	520	536	547	570	587
2500	465	517	528	545	556	579	597
2600	474	528	539	556	568	591	609
2700	485	540	552	569	582	605	624
2800	493	550	562	580	592	617	635
2900	503	563	575	594	606	631	650
3000	506	568	580	599	612	637	657
3100	514	578	590	609	623	648	668
3200	531	597	610	629	643	670	690
3300	539	607	620	640	654	681	702

RAL 9003

OUR DOORS ARE AVAILABLE IN CUSTOM SIZES TO INSURE BEST COMMERCIAL APPLICATION

TRAFFIC SWINGING DOUBLE LEAF DOORS WITH GRAVITY HINGES

ALL PRICES IN US DOLLARS, 2 MM THICK DOOR FRAME INCLUDED, VAT NOT INCLUDED

(TDD GR)

30.10.2023

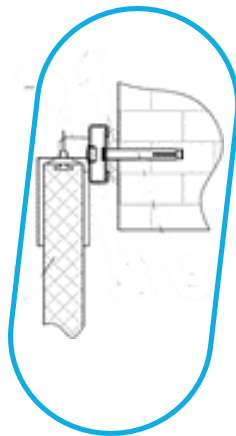

OVERHEAD FRAME

INSTALLATION OPENING, HEIGHT, MM	INSTALLATION OPENING, WIDTH, MM				
	1000	1100	1200	1300	1400
1800	590	593	600	603	664
1900	597	600	607	610	674
2000	605	608	615	619	686
2100	611	615	623	626	697
2200	618	622	630	633	707
2300	626	630	638	642	719
2400	633	637	645	649	730
2500	641	645	654	658	742
2600	654	658	666	671	759
2700				680	772
2800				690	785
2900				700	798
3000				711	813
3100				719	824
3200				728	837
3300				742	854

RAL 9003

OVERHEAD FRAME

RAL 9003	INSTALLATION OPENING, HEIGHT, MM	INSTALLATION OPENING, WIDTH, MM				
		1500	1600	1700	1800	1900
1800	667	670	673	676	679	
1900	677	681	684	687	690	
2000	689	693	696	700	703	
2100	700	704	707	711	714	
2200	711	715	718	722	726	
2300	723	727	731	735	739	
2400	734	738	742	746	750	
2500	746	750	755	759	763	
2600	763	767	772	776	780	
2700	776	781	785	790	794	
2800	790	794	799	803	808	
2900	803	807	812	817	822	
3000	818	822	827	832	837	
3100	829	834	839	844	849	
3200	842	847	852	858	863	
3300	860	865	870	875	881	

OVERHEAD FRAME

RAL 9003	INSTALLATION OPENING, HEIGHT, MM	INSTALLATION OPENING, WIDTH, MM					
		2 000	2 100	2 200	2 300	2 400	2 500
1800	682	685	688	691	695	698	701
1900	694	697	700	703	707	710	713
2000	706	710	713	717	720	723	727
2100	718	721	725	729	732	736	739
2200	730	733	737	741	744	748	752
2300	742	746	750	754	758	762	765
2400	754	758	762	766	770	774	778
2500	767	771	775	779	783	788	792
2600	784	789	793	797	801	806	810
2700	798	803	807	812	816	820	825
2800	812	817	821	826	831	835	840
2900	826	831	836	840	845	850	854
3000	842	847	852	856	861	866	871
3100	854	859	864	869	874	879	884
3200	868	873	878	883	888	893	899
3300	886	891	897	902	907	913	918

ANGULAR FRAME

RAL 9003	INSTALLATION OPENING, HEIGHT, MM	INSTALLATION OPENING, WIDTH, MM			
		1000	1100	1200	1300
1800	610	613	621	624	686
1900	619	622	630	633	698
2000	626	630	638	641	710
2100	635	639	647	651	723
2200	645	649	657	661	736
2300	652	657	665	669	748
2400	660	664	673	677	759
2500	669	674	682	687	773
2600	683	687	696	701	791
2700				713	806
2800				724	821
2900				735	835
3000				743	846
3100				753	860
3200				766	877
3300				776	891

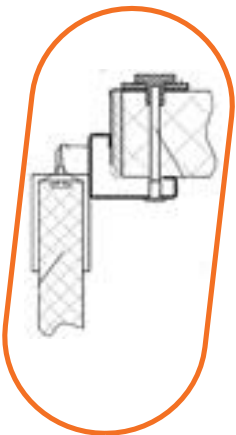

ANGULAR FRAME

	INSTALLATION OPENING, HEIGHT, MM	INSTALLATION OPENING, WIDTH, MM				
		1500	1600	1700	1800	1900
RAL 9003	1800	689	692	696	699	703
	1900	702	705	709	712	716
	2000	713	717	721	724	728
	2100	727	731	734	738	742
	2200	740	744	748	752	756
	2300	752	756	760	764	769
	2400	764	768	772	776	781
	2500	777	782	786	791	795
	2600	795	800	804	809	814
	2700	811	815	820	825	830
	2800	826	831	836	841	846
	2900	840	845	850	855	860
	3000	851	857	862	867	872
	3100	865	871	876	881	887
	3200	882	888	893	899	904
	3300	896	902	908	913	919

ANGULAR FRAME

	INSTALLATION OPENING, HEIGHT, MM	INSTALLATION OPENING, WIDTH, MM						
		2 000	2 100	2 200	2 300	2 400	2 500	2 600
RAL 9003	1800	706	710	713	716	720	723	727
	1900	720	723	727	730	734	738	741
	2000	732	736	739	743	747	750	754
	2100	746	750	754	758	762	765	769
	2200	761	765	769	773	777	781	785
	2300	773	777	781	785	790	794	798
	2400	785	789	794	798	802	807	811
	2500	799	804	808	813	817	822	826
	2600	818	823	827	832	837	841	846
	2700	834	839	844	849	853	858	863
	2800	851	856	861	865	870	875	880
	2900	865	871	876	881	886	891	896
	3000	877	883	888	893	898	903	909
	3100	892	897	903	908	913	919	924
	3200	910	915	921	926	932	937	943
	3300	925	930	936	941	947	953	959

OVERLAPPING FRAME

	INSTALLATION OPENING, HEIGHT, MM	INSTALLATION OPENING, WIDTH, MM				
		1000	1100	1200	1300	1400
RAL 9003	1800	681	686	695	700	764
	1900	691	696	705	710	778
	2000	701	706	715	720	791
	2100	714	719	729	734	809
	2200	724	730	739	744	823
	2300	735	740	750	755	837
	2400	748	754	763	769	855
	2500	758	764	774	780	870
	2600	772	778	789	794	888
	2700				807	904
	2800				820	921
	2900				833	937
	3000				840	947
	3100				852	963
	3200				876	991
	3300				888	1007

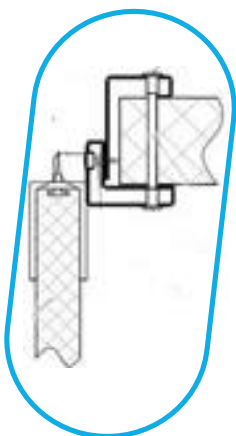

OVERLAPPING FRAME

	INSTALLATION OPENING, HEIGHT, MM	INSTALLATION OPENING, WIDTH, MM				
		1500	1600	1700	1800	1900
RAL 9003	1800	768	773	778	782	787
	1900	782	787	792	797	801
	2000	796	801	806	811	816
	2100	814	819	824	829	834
	2200	828	833	838	844	849
	2300	842	848	853	859	864
	2400	860	866	871	877	882
	2500	875	881	887	892	898
	2600	894	900	905	911	917
	2700	910	916	922	928	934
	2800	927	933	939	945	951
	2900	944	950	956	962	969
	3000	953	960	966	972	979
	3100	970	976	983	989	996
	3200	997	1004	1011	1018	1024
	3300	1014	1021	1028	1035	1042

OVERLAPPING FRAME

	INSTALLATION OPENING, HEIGHT, MM	INSTALLATION OPENING, WIDTH, MM						
		2 000	2 100	2 200	2 300	2 400	2 500	2 600
RAL 9003	1800	792	796	801	805	810	815	819
	1900	806	811	816	821	825	830	835
	2000	821	826	831	836	841	846	851
	2100	840	845	850	855	860	865	870
	2200	854	860	865	870	875	881	886
	2300	870	875	880	886	891	897	902
	2400	888	894	899	905	910	916	922
	2500	904	909	915	921	926	932	938
	2600	923	929	935	940	946	952	958
	2700	940	946	952	958	964	970	976
	2800	957	963	970	976	982	988	994
	2900	975	981	988	994	1000	1006	1013
	3000	985	992	998	1004	1011	1017	1023
	3100	1002	1009	1015	1022	1028	1035	1041
	3200	1031	1038	1045	1052	1058	1065	1072
	3300	1049	1056	1062	1069	1076	1083	1090

OUR DOORS ARE AVAILABLE IN CUSTOM SIZES TO INSURE BEST COMMERCIAL APPLICATION

DOOR CATALOGUE CODES

TSD	SWINGING SINGLE LEAF DOORS
TDD	SWINGING DOUBLE LEAF DOORS
RIGHT / LEFT	HINGES ON THE RIGHT / HINGES ON THE LEFT

EXAMPLE OF DOOR CATALOGUE CODE: TSD 800 2000 40 RAL9003/RAL9003 ANG RIGHT

DOOR TYPE	DOORWAY WIDTH	DOORWAY HEIGHT	DOOR THICKNESS	COVERING MATERIAL		FRAME TYPE	HINGES LOCATION
				EXTERIOR METAL	INTERIOR METAL		
TSD	800	2 000	40	RAL9003	RAL9003	ANGULAR	RIGHT

ADDITIONAL OPTIONS FOR TRAFFIC SWINGING DOORS

ITEM	PRICE
TDD FRAME INSTALLATION HARDWARE TO INSULATED SANDWICH PANELS	13
TSD FRAME INSTALLATION HARDWARE TO INSULATED SANDWICH	9
TDD FRAME INSTALLATION HARDWARE TO A BRICK WALL	8
TSD FRAME INSTALLATION HARDWARE TO A BRICK WALL	4
FRAME INSTALLATION HARDWARE FOR STEEL STUD CONSTRUCTION	2
DOOR BLADE MATERIAL: AISI 304, PRICE FOR 1 SQ. M	33
DOOR BLADE MATERIAL: AISI 430, PRICE FOR 1 SQ. M	23
OVERHEAD FRAME AISI 304, PRICE FOR RUNNING METER	22
ANGULAR FRAME AISI 304, PRICE FOR RUNNING METER	35
OVERLAPPING FRAME AISI 304, PRICE FOR RUNNING METER	82
OVERHEAD FRAME AISI 430, PRICE FOR RUNNING METER	13
ANGULAR FRAME AISI 430, PRICE FOR RUNNING METER	20
OVERLAPPING FRAME AISI 430, PRICE FOR RUNNING METER	47
HIDDEN INSTALLATION HARDWARE FOR TSD	45
HIDDEN INSTALLATION HARDWARE FOR TDD	53
HIDDEN INSTALLATION HARDWARE FOR TSD WITH AISI 304 FRAME	62
HIDDEN INSTALLATION HARDWARE FOR TDD WITH AISI 304 FRAME	73
HIDDEN INSTALLATION HARDWARE FOR TSD WITH AISI 430 FRAME	55
HIDDEN INSTALLATION HARDWARE FOR TDD WITH AISI 304 FRAME	65

FACTORY INSTALLED BUMPERS FOR TSD

BUMPER MATERIAL	THICKNESS, MM	PRICE FOR SQ. M	PRICE FOR RUNNING METER	
			BOTTOM 0,25 M	BOTTOM 0,5 M
AISI 304	1,5	110	27	55
AISI 430	1,5	73	18	36
ALUMINIUM CHECKER PLATE	1,5	58	14	29
FLAT HDP PLASTIC	4,0	33	8	16
CURVED HDP PLASTIC	6,0	47	12	24

FACTORY INSTALLED BUMPERS FOR TDD

BUMPER MATERIAL	THICKNESS, MM	PRICE FOR SQ. M	PRICE FOR RUNNING METER	
			BOTTOM 0,25 M	BOTTOM 0,5 M
AISI 304	1,5	115	29	58
AISI 430	1,5	76	19	38
ALUMINIUM CHECKER PLATE	1,5	61	15	31
FLAT HDP PLASTIC	4,0	34	8	17
CURVED HDP PLASTIC	4,0	39	10	19
CURVED HDP PLASTIC	6,0	48	12	24

PACKAGING

ITEM	PRICE
STRETCH-WRAP	INCLUDED IN DOOR PRICE
CARDBOARD PACKAGING	CALCULATED INDIVIDUALLY FOR YOUR ORDER
WOODEN PACKAGING	CALCULATED INDIVIDUALLY FOR YOUR ORDER

